**FAG****53309**

Axial deep groove ball bearing

Schaeffler ID:
0167159000000

Axial deep groove ball bearing 533, single direction, with spherical housing washer, steel sheet metal cage

Technical information

Main Dimensions & Performance Data

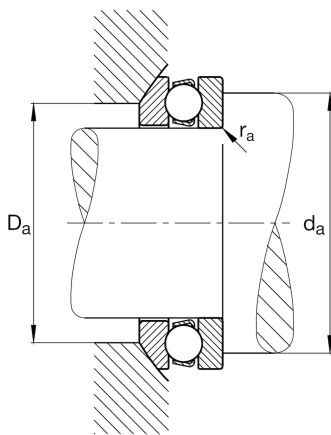
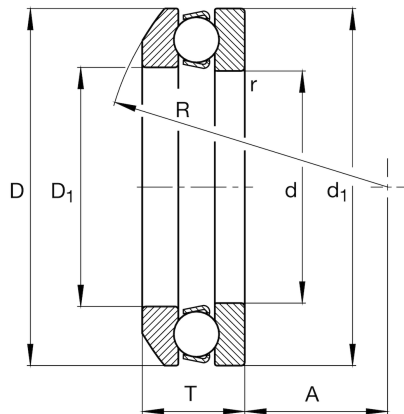

d	45 mm	Bore diameter
D	85 mm	Outside diameter
T	30.1 mm	Height
C_a	75,000 N	Basic dynamic load rating, axial
C_{0a}	140,000 N	Basic static load rating, axial
C_{ua}	6,500 N	Fatigue load limit, axial
n_G	3,800 1/min	Limiting speed
n_{gr}	6,800 1/min	Reference speed
	0.68 kg	Weight

Dimensions

r_{min}	1 mm	Minimum chamfer dimension
D_1	47 mm	Bore diameter housing washer
d_1	85 mm	Lip diameter shaft washer
R	64 mm	Radius spherical housing washer
A	25 mm	Distance of the center point
T_1	33 mm	Height with seat washer

Mounting dimensions

$d_{a min}$	69 mm	Minimum diameter shaft shoulder
$D_{a max}$	65 mm	Maximum diameter of housing shoulder
$r_{a max}$	1 mm	Maximum recess radius

Additional information

A	0.12	Minimum load factor
	U309	Seat washer

Temperature range

T_{min}	-30 °C	Operating temperature min.
T_{max}	150 °C	Operating temperature max.